

x15G optoSiC+inclusiv glued SM-mount for 7 mm shaft

J = 2.05g*cm²
M = 6.63g

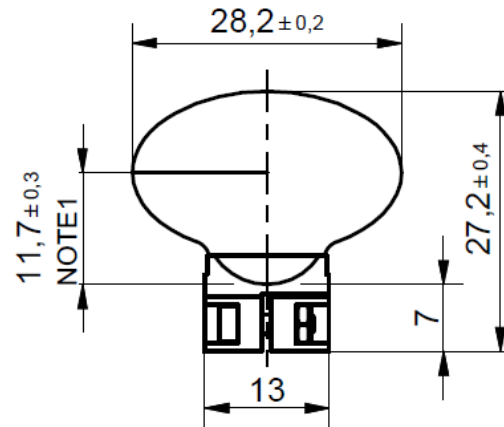
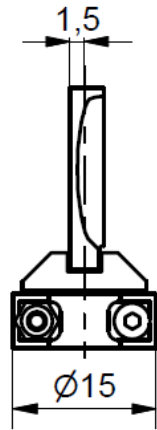

Notes:

1. Dimension from end of the shaft to the center of the clear aperture.
2. Screw size = M2x8mm
3. Nut size = M2
3. Hex Key Size = 1,5mm
4. Recommended screw torque : 0,25Nm
5. Bore-Diameter 7H7

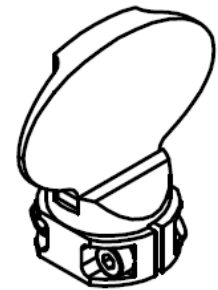

y15G optoSiC+inclusiv glued SM-mount for 7 mm shaft

$J = 2.05g \cdot cm^2$
 $M = 7.53g$

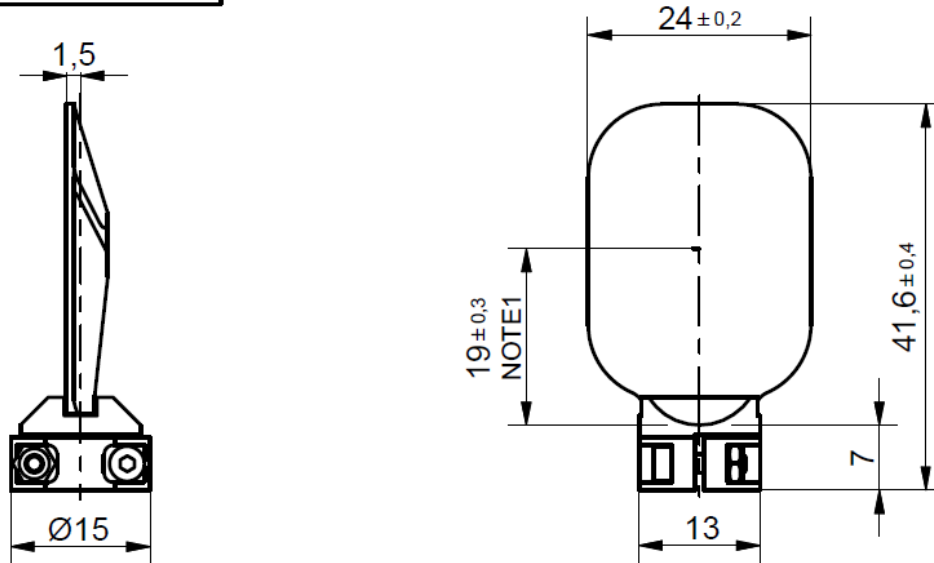

Notes:

1. Dimension from end of the shaft to the center of the clear aperture.
2. Screw size = M2x8mm
3. Nut size = M2
3. Hex Key Size = 1,5mm
4. Recommended screw torque : 0,25Nm
5. Bore-Diameter 7H7

