

optoSiC® X45G with Mount for 10mm shaft

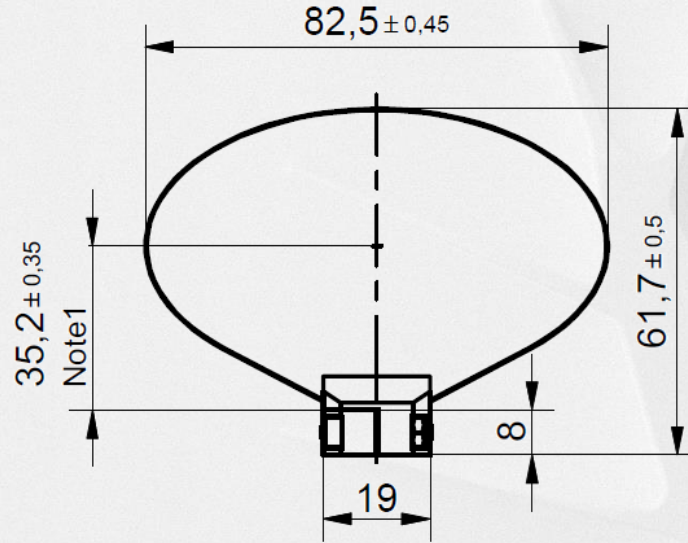

$$J = 78,3g \cdot cm^2$$
$$M = 35,6g$$

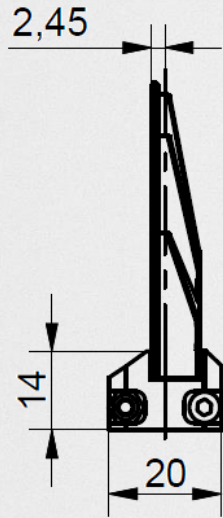
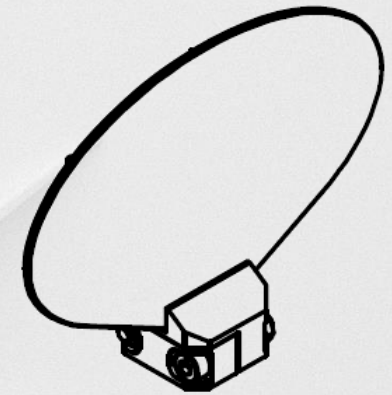

Notes:

1. Dimensions from end of the shaft to the center of the clear aperture.
2. Screw size = M3x16mm
3. Nut size = M3
4. Hex key size = 2,5mm
5. Recommended/Maximum screw torque: 1,8Nm
6. Bore for Shaft: Diameter: 10H7; Depth: 8,0 +/- 0,1mm

optoSiC[®] Y45G with Mount for 10mm shaft

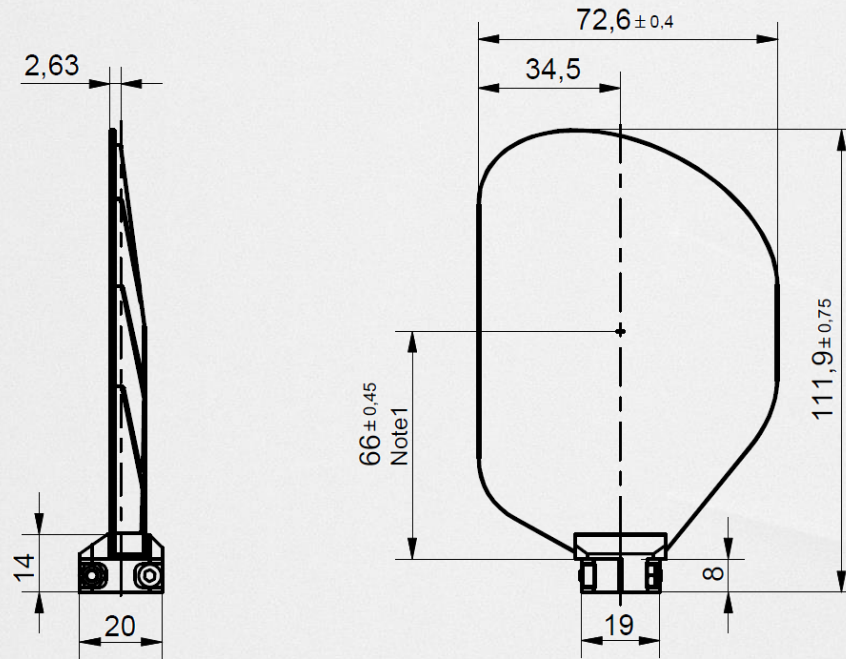

$$J = 120,9\text{g}\cdot\text{cm}^2$$
$$M = 61,3\text{g}$$



Notes:

1. Dimensions from end of the shaft to the center of the clear aperture.
2. Screw size = M3x16mm
3. Nut size = M3
4. Hex key size = 2,5mm
5. Recommended/Maximum screw torque: 1,8Nm
6. Bore for Shaft: Diameter: 10H7; Depth: 8,0 +/- 0,1mm